

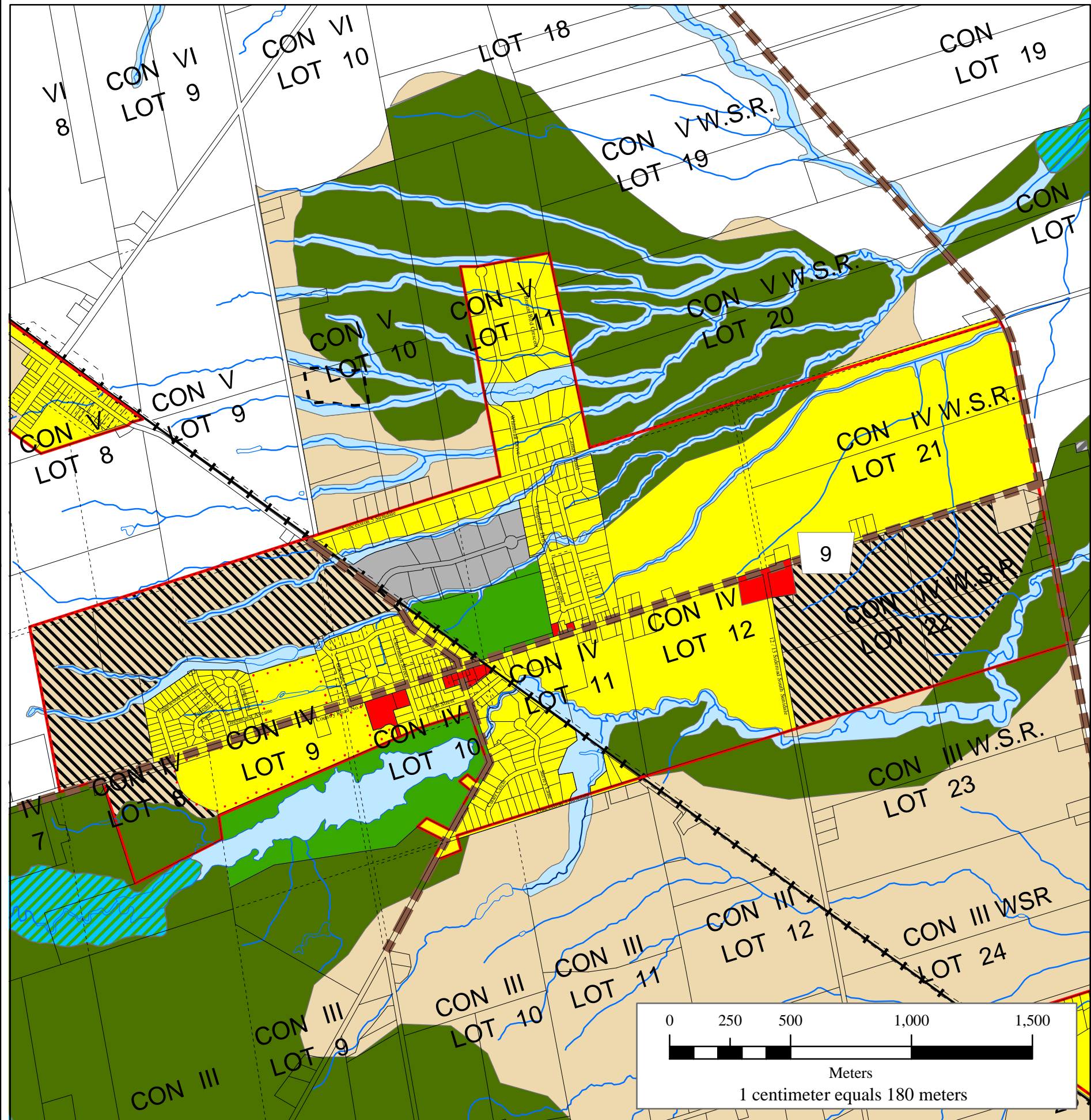

OFFICIAL PLAN of the TOWNSHIP OF CLEARVIEW

Schedule A2 - New Lowell Land Use and Transportation Plan Secondary Urban Settlement Area



- Land Use - General**
- Greenland - Hazard Land Areas
 - Greenland - Natural Heritage Areas
 - Greenland - Wetland Areas
 - Open Space
 - Agriculture
 - Rural

- Land Use - Niagara Escarpment Plan Area**
- Escarpment Natural Area
 - Escarpment Protection Area
 - Escarpment Recreation Area
 - Escarpment Rural Area
 - Mineral Resource Extraction Area
 - Public Land in the Parks System

- Residential
- Estate Residential
- Special Policy Residential
- Future Development
- Commercial
- Commercial Transition Area
- Future Commercial
- Extractive Industrial
- Industrial
- Mineral Aggregate Resource Area
- Waste Disposal Industrial

- Boundary Classifications**
- Waste Disposal Assessment Area
 - Boundary of the Niagara Escarpment Plan
 - Special Development Area - Collingwood Airport
 - Urban Settlement Area Boundary
 - Special Servicing Area
 - Recreational District

- Transportation**
- Provincial Highways
 - Arterial Roads
 - Collector Roads
 - Local Roads
 - Railway Lands / Water Transmission Line

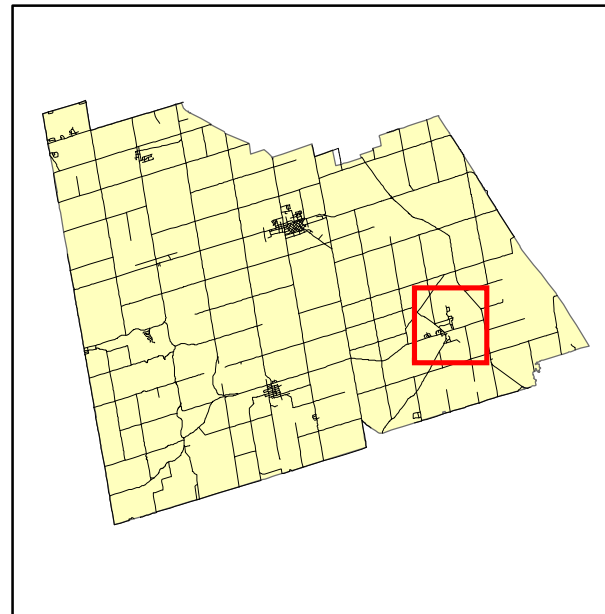

Projection: Universal Transverse Mercator
Mapping Date: 21 March, 2002
Parcel and hydrological data provided by
Simcoe County
Land Information Network Co-Operative.
NOTE: This map is not a legal survey.